

# HILL TOP SHOPPING CENTER

SPOTSYLVANIA, VIRGINIA

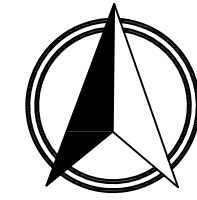

NORTH

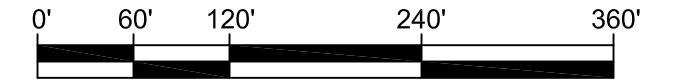

GRAPHIC SCALE: 1"= 120'

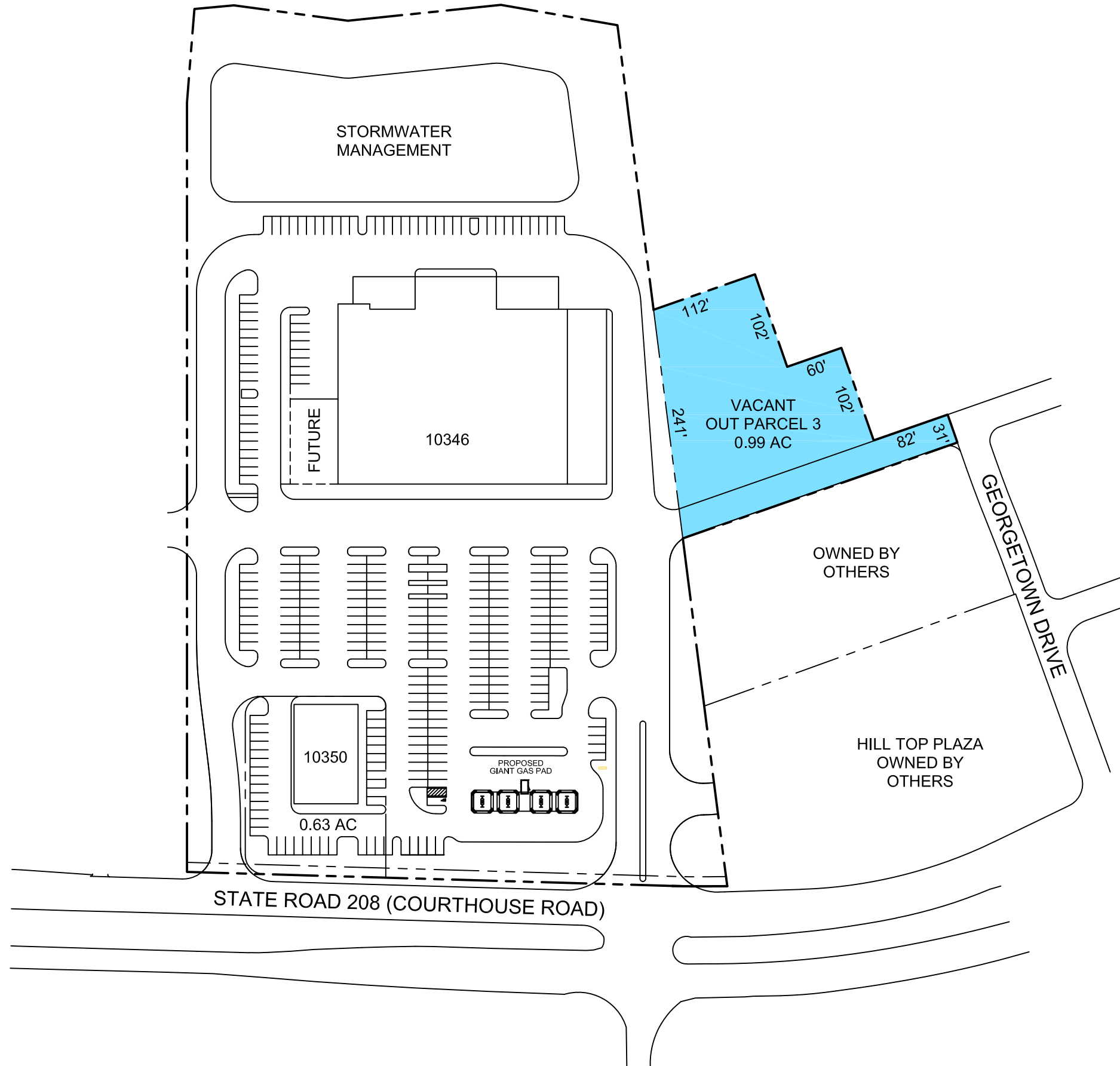

CR- COURTHOUSE ROAD SPOTSYLVANIA, VA 22553		
UNIT NO.	TENANT	LEASED SQ. FT.
10346 CR	GIANT FOOD	58,318
	FUTURE GAS PAD	1,500
10350 CR	HONEST-1 AUTO CARE	5,040
TOTAL SQUARE FOOTAGE =		64,858
OP3	VACANT	0.99 AC

VACANT